

## STANDARD SPECIFICATIONS

### MODEL DESIGNATION LEU603

#### ENGINE: MACK MP7-325M

Peak Horsepower – 325HP at 1500-1900 RPM  
Horsepower – 300 HP at 2100 Gov. RPM  
Max. Torque – 1200 lb/ft at 1200 RPM  
V-MAC IV – Total Vehicle Electronics  
Air Compressor – Meritor/WABCO 636 (37.4 cfm)  
Air Cleaner, 15" Single Element w/Snorkel Intake  
Alternator, Leece Neville 12V 160A  
Batteries, (3) Mack 12V M/F Group – 650 CCA  
Total 1950 CCA Treaded Stud Type Terminals  
Coolant Protection - 34°F (-37°C)  
Mack Coolant Conditioner  
Diesel Particulate Filter – Vertical RH Side Back of Cab  
Exhaust After Treatment System, Ceramic Non-Catalyzed  
Engine Block Heater, 120V 1500W  
Silicone Engine Hoses and Tubing  
Fan Drive, Electronically Modulated Type  
Flywheel Housing, Aluminum  
Fuel-Water Separator - Mack  
Silicone Radiator & Heater Hoses  
Starter, 12V Gear Reduction  
Electronic Starter Interlock

#### TRANSMISSION: ALLISON 4500-RDS-6

6-Speed Automatic  
Ratios: 4.70 Low – 0.67 High  
Includes: Direct Mount Oil Cooler, External Oil Cooler,  
Internal Filter and Oil Level Sensor  
Driveline: Meritor 17N HD w/Coated Splines

#### CAB: LOW ENTRY LH DRIVE w/RH Operating Position

Air Restriction Monitor, Graduated Lock Up Type  
Air Cleaner Intake Mounted  
Ash Tray w/Hinged Cover  
Cab Mounting, Four Point Fixed Type  
Cab Tilt, Mounted on RH Fender Bracket  
Cigar Lighter  
Coat Hook, (1)  
Dome Lights: 2 w/Self-contained Switch  
Doors: RH Rear Opening Fold Up Door and LH Door  
w/Roll-up Window  
Engine Shutoff – Key Type Control  
Dual Air Pressure Gauge  
Voltmeter  
Engine Coolant Temperature Gauge  
Engine Oil Pressure Gauge  
Fuel Level Gauge  
Speedometer w/Odometer Proximity Pick-up and Magnetic Sensor  
Tachometer w/Hourmeter  
Transmission Oil Temperature Gauge  
Safety Tinted Windshield w/Non-Tinted Side and Rear Windows  
Grab Handles, Aluminum RH & LH Behind Door  
Heater w/Integral Defroster  
Horn, (1) Twin Trumpet w/Dual Lanyard Control  
Single Tone Electronic  
Identification and Clearance Lights (7)  
Interior Trim: Silver Gray Vinyl  
Keys, 2 – Keyed at Random  
Exterior Mirrors, LH and RH Motorized w/ Heated Retractable  
Arms and Brackets

# MACK

## TerraPro Low Entry 6X4 SERIES



- Low Entry Tilt Cab
- Dual Control, Right-Hand Low Entry Stand-Up Operating Position
- 6-Wheel Truck
- ABS (Anti-Lock Brake System)

#### STANDARD

**ENGINE:** MACK MP7-325M  
325 HP [243 kW] Peak Horsepower

**TRANSMISSION:** ALLISON, 4500 RDS  
6-Speed Automatic

**FRONT AXLE:** MACK FXL20  
20,000 lb. [9 072 kg] Capacity

**REAR AXLE:** MACK SS462  
46,000 lb. [20 866 kg] Capacity  
Suspension: Multileaf Spring



## STANDARD SPECIFICATIONS

(Continued)

### CAB: CA68 CONVENTIONAL (Continued)

Front Fender Mounted Mud Flaps  
Parking Brake Control w/Warning Light  
CB – 5 way Binding Post  
Rear Window, Fixed  
Seating:  
Driver – Bostrom Talladega 910 Mid-Back Air Suspension  
w/Black Dupont Covering  
Rider – Mack Fold Up w/ Black Dupont Covering  
Seat Belts, Lap and Shoulder for Driver  
Lap for Fold Up Rider Seat  
Seat Belt Retractors  
Side Markers, Lamps and Reflectors  
Key Type Starter Switch  
Steering Column, Fixed  
Sun Visor, Interior Both Sides  
Turn Signal Switch, Manual Cancelling  
Ventilation, LH Door Vent  
Windshield Protector  
Windshield Washers, Wiper Mounted with 7qt Reservoir  
Windshield Wipers:  
2 Speed Electric Motor w/Intermittent Feature  
Hydraulic Pump Mtg. Provisions

### FRAME:

Wheelbase (WB) – 197"  
Load Platform (LP) – 286"  
Cab to Axle (CA) – 206"  
Axle to End of Frame (AF) – 80"  
Frame Rails – Steel  
Cross Section – 13.38" x 3.25" x .38"  
Section Modulus, 23.49 in.<sup>3</sup>  
RBM (per rail) – 2,818,800 lb. in.  
Bumper: Painted Steel Flush Mounted  
Bumper to Back of Cab (BBC) – 59"  
Crossmembers: ½" Plate Type Bolted Back of Cab  
Intermediate ⅜" Below Rail  
Front Tow Pin

### FUEL TANKS:

Capacity/Location: 70 Gallon RH  
Steel, 24" Diameter  
Fuel Lines, Aeroquip Fire Resistant

### FRONT AXLE: MACK FXL20

20,000 lb. Capacity  
Tires: 315/80R22.5  
Wheel Equipment: (2) 22.5" x 8.25" Steel Disc  
10-Hole Hub Piloted  
Brakes: Meritor "S" Cam 16.5" x 6" Q-Plus w/o Dust Shields  
Cast Outboard Mounted Brake Drums  
Slack Adjusters – Automatic  
Suspension: Mack Taperleaf 20,000 lb. Ground Load Rating  
Static Load Cushions  
Steering: M100P Plus Right Side Assist Cylinder

### REAR AXLE: MACK S462

46,000 lb Capacity  
Carrier – Malleable CRDPC92/CRD93  
Suspension – SS462 Mack Multileaf 46,000 lb Capacity  
Tires: 11R22.5 Duals  
Wheel Equipment: (8) 22.5 x 8.25 Steel Disc  
10-Hole Hub Piloted  
Brakes: Meritor "S" Cam 16.5" x 7" Q-Plus w/o Dust Shields  
Wheel Seals – Oil  
Slack Adjusters – Automatic  
Spring Brake Chambers:  
(4) 30/30 Double Diaphragm Type  
Mechanical Spring Release  
Transverse Torque Rod (Rear Axle Only)

### AIR/BRAKE:

Dual Air Brake System  
Dual Air Dryer for CTI w/Cooling Tank  
Air Reservoirs – Steel  
Bendix Anti-Lock Brake System  
Automatic Drain Valve, Heated  
Work Brake

### ELECTRICAL:

Backup Alarm – Preco Model 1059  
Battery Box – Painted Steel w/Locking Tab  
Battery Disconnect Switch, Mtd. RH Side of Battery Box  
Battery Switch Warning Light  
Daytime Running Lights:  
Engine Running Activated  
Electric Circuit Protection Package  
12V w/Circuit Breakers  
Negative Ground System  
Waterproof Electrical Connections  
Control Link  
Headlamps – (2) Single Round Halogen Lamps  
Rear Lighting  
Single Flasher, Kysor

### PAINT:

Cab, Hood and Fenders:  
Mack White (High Gloss)  
Urethane Base Coat w/o Clear Coat  
Chassis Running Gear:  
Mack Black (Urethane)

### WEIGHT:

Font: 10,653  
Rear: 6,984  
TOTAL: 17,637

**CHASSIS SPECIFICATIONS**

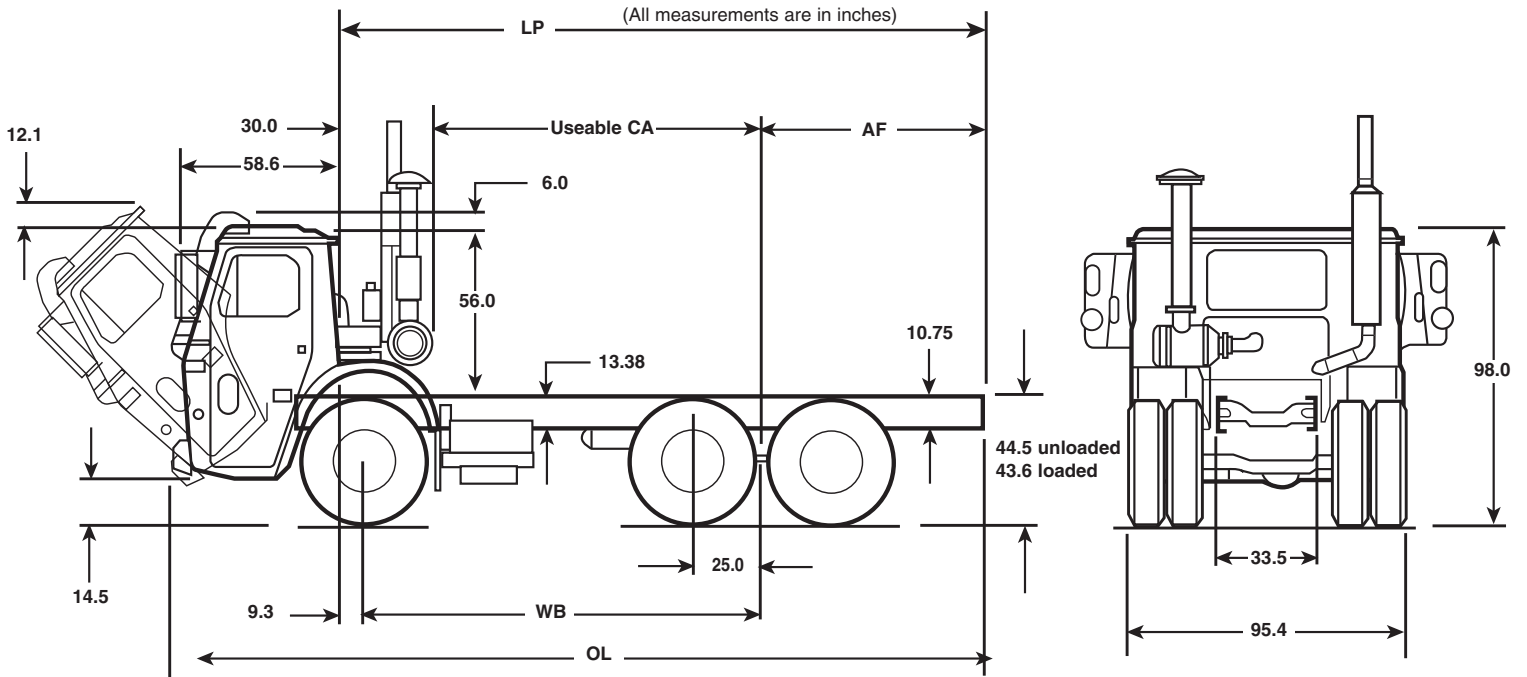

**DROP FRAME**

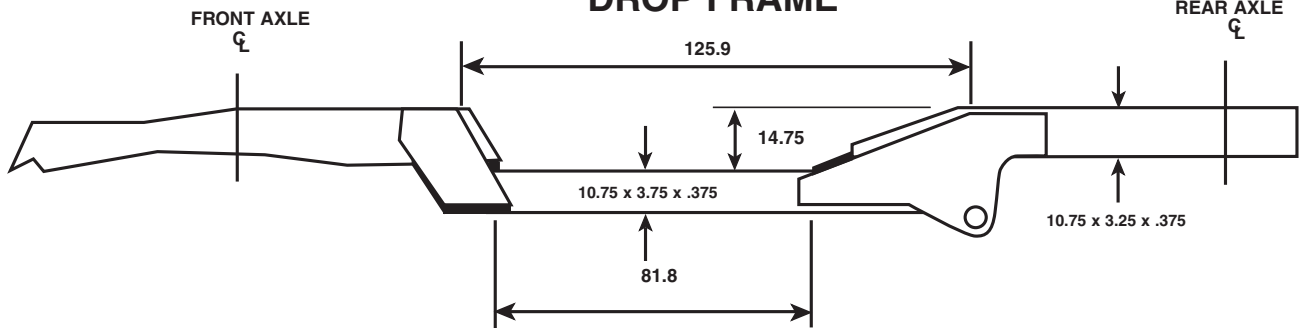

WB WHEELBASE	LP PLATFORM	USEABLE CA	AF
250	320	"Drop Frame"	61
173	286	152.3	104
186	286	165.3	91
197	286	176.3	80
210	286		67
246	322		67

MP7—ENGINES	
MODEL	HORSEPOWER
<b>MACK</b>	
MP7-345C	345 HP [257 kW] @ 1500-1700 RPM 320 HP [239 kW] @ 1950
MP7-325M	325 HP [242 kW] @ 1500-1900 RPM 300 HP [224 kW] @ 2100

TRANSMISSIONS		
MODEL	SPEEDS	RATIOS (LOW/HIGH)
<b>ALLISON</b>		
4500 RDS	5	4.70/0.76
4500 RDS	6	4.70/0.67

AXLES		
CAPACITY	MAKE	MODEL
<b>FRONT AXLES</b>		
20,000 lb. [9 072 kg]	MACK	FXL20
<b>TANDEM REAR AXLES</b>		
38,000 lb. [17 237 kg]	MACK	S38R
46,000 lb. [20 866kg]	MACK	S462
	MERITOR	RT46-160
52,000 lb. [23 600kg]	MACK	S522

## OPTIONAL EQUIPMENT

### WHEELBASE/LP:

Wheelbase Availability: 173" to 250"

LP Availability: 286" to 320"

See MackTraQ for all available Combinations

### SPECIAL SALES PACKAGES:

Left Hand Sitdown Drive Package

Drop Frame Package

Right Hand Drive Option

Dual Sitdown Drive Option

See MackTraQ for Detailed Information on Special Sales Packages

### OTHER OPTIONAL EQUIPMENT:

Additional Alternator Options

Battery Option – (4) Mack 12V

Chassis Keyed Alike

Convex Mirrors

Coolant Protection -10°F (-23°C)

Engine Block Heater – 240V 1500W

Engine Brake – Mack Powerleash

Gauge Option:

Exhaust Pyrometer

Metric

Inside Frame Reinforcement

LH Fuel Tank

Personalized Name Plate

Rear View Camera Prep Kit

Rear Axle Option

Roof Vents

Skid Plate

Starter Option – 12V Delco MTDH 39

Stereo Cassette/Stereo CD Radio Options

Synthetic Lubricants

Wheel Lugwrench

OTHER COMPONENT OPTIONS MAY BE  
AVAILABLE UPON REQUEST