

STANDARD SPECIFICATIONS

ENGINE: MACK, AI-300A ASET

Horsepower, 300 HP [224 KW] at 1950 Gov. RPM
Peak Horsepower, 325 HP [243 kW] at 1700 RPM
Max. Torque, 1200 lb/ft [1 627 N•m] at 1300 RPM
V-MAC III—Total Vehicle Electronics
Air Compressor, 16.5 CFM
Alternator, Delco 12V 100A (22SI)
Batteries, Three (3) 12V Mack, 650/1950 CCA
Air Cleaner, 15" Single Element, Snorkel Intake
w/Inline Precleaner
Exhaust, Single Vertical w/Rain Cap & Muffler Shield
Coolant Protection -10°F
Engine Heater 120V 1500W
Fan Drive, On-Off
Poly-V Fan Belt
Extended Service Interval, ESI w/Centri Max
w/2 Full-Flo Oil Filters, and 16K Mile Service Interval
Flywheel Housing, Aluminum
Starter, 12V Delco, Type 450 42MT
V-MAC Engine and Transmission Shutdown
Protection System

TRANSMISSION: ALLISON, 4500 RDS—5 Speed

5-Speed Automatic
Ratios: 4.70 Low–0.76 High
TC541 Torque Converter
Neutral to Range Inhibit
Oil Resistant Mounts
Driveline: Meritor 17N HD Main & 17N HD Interaxle
w/Coated Splines

CAB: Low Entry Cab Forward Galvanized Steel

LH Standard Drive Position w/RH Operating Position
Air Restriction Monitor Air Cleaner Mtd.
Cab Lift/Tilt on RH Fender
Cigar Lighter
Gauges: Dual Air Pressure, Voltmeter, Engine Coolant
Temperature, Transmission Temperature, Transmission
Oil Level, Hobbs Engine Hourmeter, Engine
Oil Pressure, Fuel Level
Electronic Speedometer w/Odometer
Electronic Tachometer
Windshield Protector
Tinted Windshield
Heater w/Integral Defroster
High Beam Indicator Light
Horns—Air, Twin Trumpet (Mtd. Under Cab) and
Elec. Single Tone w/ Dual Lanyards
Identification/Clearance Lights, (7) Marker & Clearance
Interior Trim—Color to be the same as Exterior paint
Low Air Pressure Indicator Light & Buzzer
Mirrors, Exterior—Moto Mirror Package LH & RH
Motorized and Heated

MAC K

LE613 SERIES

CHASSIS



- Low Entry Tilt Chassis
- Dual Control, Right-Hand Low Entry Stand-Up Operating Position
- 6-Wheel Truck
- ABS (Anti-Lock Brake System)

STANDARD

ENGINE: MACK AI-300A ASET
325 HP [243 kW] Peak Horsepower

TRANSMISSION: ALLISON, 4500 RDS
5-Speed Automatic

FRONT AXLE: MACK FAW20
20,000 lb. [9 072 kg] Capacity

REAR AXLE: MACK SS462
46,000 lb. [20 866 kg] Capacity
Suspension: Multileaf Spring



STANDARD SPECIFICATIONS

(Continued)

CAB: continued

Daytime Running Lights
Parking Brake Control w/Warning Light
Key Start/Shutoff
Steering Column, Fixed
5-Way Binding Post for CB Radio
Driver Seat—Bostrom Talladegha 910 (Mid Back)
w/Black Dupont Covering
Rider Seat—Fold-Up MACK,
w/Black Dupont Cordura Covering
Seat Belts (Orange)/Retractors, Lap & Shoulder for
Driver's Seat, Lap for Fold-up Rider's Seat
Cab Doors, RH Rear Opening Fold-Up
and LH Std. Door w/Roll-Up Window
Sun Visor, Interior—Both Sides
Turn Signal Switch, Signal Stat 915 Series
Front Fender Mud Flaps, 12"
Windshield Washers, Electric Wiper Mtd.
w/7 qt Reservoir
Windshield Wipers Spraque—2-Speed Electric
w/Intermittent Feature

FRAME:

Frame Rail: 13.38" x 3.25" x .375"
Combined Rating: 23.49 SM, 110,000 PSI Steel;
2,580,000 lb. in. RBM
Wheelbase/Platform: Depends on Sales Package Chosen
Bumper, Channel Type Flush Mounting, Painted Steel
Crossmembers: 0.5" Thick Back-to-Back Plate Type,
Back of Cab and Intermediates, Mtd. 0.125"
Below Top of Frame Rail
Towing Device, Front Tow Pin
Without Inside Frame Liner

FUEL TANKS:

70 Gal RH 24" Dia. Steel, Mtd. 5.0" from Top of Frame Rail
Filler Neck Screen
Fuel Lines, Aeroquip Fire Resistant

FRONT AXLE: MACK, FAW20

20,000 lb [9 072 kg] Capacity
Wheels: Steel Disc, 22.5" x 9.0"
Brakes: Meritor Q Plus—Type "S" Cam 16.5" x 6"
Hubs, Ferrous
Brake Drums, Cast Outboard
Slack Adjusters—Automatic
Springs: MACK Multileaf 20,000 lb Ground Load Rating
Static Load Cushions
Steering, Power: w/RH Assist Cylinder
Wheel Seals—Oil
Tires: 315/80R22.5 (singles)

REAR AXLE: MACK, SS462

46,000 [20 866 kg] lb Capacity
Suspension: MACK Multileaf Spring 46,000 lb Capacity
Carrier, Malleable (CRDPC92/CRD93)
Wheels: Steel Disc, 22.5" x 8.25"
Brakes: Meritor Q Plus—Type "S" Cam 16.5" x 7"
Hubs, Ferrous
Brake Drums, Cast Outboard
Slack Adjusters—Automatic
Shock Insulator, Urethane
Trunnion Bushing, Urethane
50" Axle Spacing
Transverse Torque Rod (Rear-Rear Axle)
Brake Chambers: Type 30/30, qty, Four (4)
High Mount Brake Chambers (Rear-Rear Axle)
Wheel Seals—Oil
Tires: 11R22.5 (duals)

AIR/BRAKE:

ABS (Anti-Lock Brake System)
Work Brake
Air Dryer—Heated
Air Reservoirs, Relocation—Inboard Forward of Bogie
High Mounted Air Lines
Automatic Drain Valve—Heated
Bendix Switches and Valve Where Possible

ELECTRICAL:

Backup Alarm, Preco Model 1059
Battery Disconnect Switch,
Flaming River Industries "Big Switch"
Battery Disconnect Indicator Light Near Battery Box
Battery Box, Painted Steel w/Tether Device, mtd. 6.5"
From Top of Frame Rail Behind LH Fender
HD Back-Up Switch Relay
Electrical Circuit Package, Automatic Reset Circuit Breakers
Body Power Cable HD w/1 Junction Box at End of Frame
and 1 Junction Box Outside LH Frame Rail BOC
Electrical Connections, Water Proofed
Electrical Schematic
Transistorized Flasher
Headlamps, Halogen—Single Round without Rear Lighting

PAINT:

Cab, Fenders
Color, MACK White (High Gloss)
Polyurethane Base Coat
Chassis Running Gear: Color, MACK Black (Urethane)
Rims: Color, Pre Painted White by Accuride

PTO/SPECIAL/ADDITIONAL EQUIPMENT:

Crankshaft Adapter, 1350 Series Flange
Provisions for Front Mounted Pump

WEIGHT:

Front: 10,525
Rear: 6,939
TOTAL: 17,464

CHASSIS SPECIFICATIONS

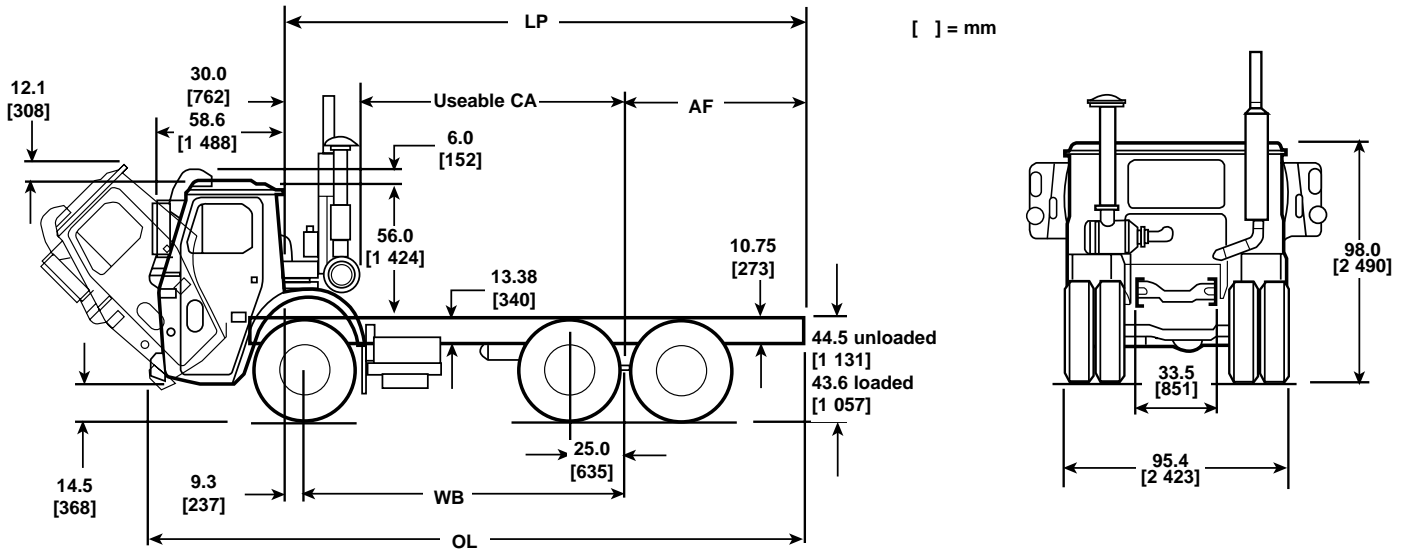

DROP FRAME

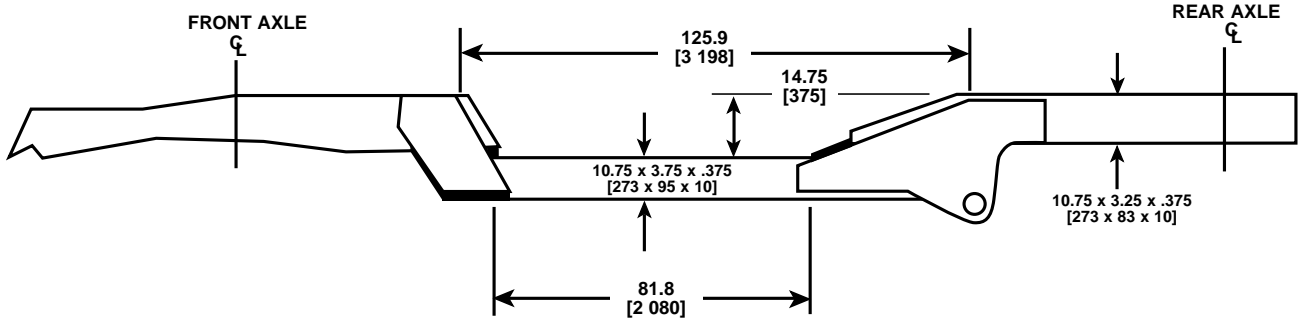

WB WHEELBASE	LP PLATFORM	USEABLE CA	AF
250 [6 350]	320 [8 128]	"Drop Frame"	70 [1 778]
173 [4 394]	286 [7 264]	152.3 [3 868]	113 [2 870]
186 [4 724]	286 [7 264]	165.3 [4 198]	100 [2 540]
197 [5 004]	286 [7 264]	176.3 [4 478]	89 [2 261]
210 [5 334]	286 [7 264]		76 [1 930]
246 [6 248]	322 [8179]		

AVAILABLE DRIVELINE COMPONENTS

ENGINES	
MODEL	*HORSEPOWER @ GOV'D. RPM
MACK	
AI-300A ASET IEGR	300 HP [224 kW] @ 1950 325 HP [243 kW] @ 1700
AI-350 ASET IEGR	350 HP [261 kW] @ 1950 350 HP [261 kW] @ 1600-1950

*Italics = Peak horsepower other than gov'd. RPM

AXLES		
CAPACITY	MAKE	MODEL
FRONT AXLES		
20,000 lb. [9 072 kg]	MACK	FAW20
TANDEM REAR AXLES		
38,000 lb. [17 237 kg]	MACK	SS38R (Opt.)
46,000 lb. [20 866kg]	MACK	SS462
46,000 lb. [20 866kg]	MACK	SH462

TRANSMISSIONS		
MODEL	SPEEDS	RATIOS (LOW/HIGH)
ALLISON		
4500 RDS	5	4.70/0.76
4500 RDS	6	4.70/0.67
4500 RDS R	5	4.70/0.76
4500 RDS R	6	4.70/0.67

OPTIONAL EQUIPMENT

OTHER OPTIONAL EQUIPMENT:

- Aluminium Hubs
- Chassis Keyed Alike
- Convex Mirrors
- Electrical Circuits, Specialized
- 1/4" Inside Frame Reinforcement
- Gauge Options:
 - Metric
 - Transmission Oil Level
- Hydraulic Pump (Muncie), w/o Driveline
- Interwheel Power Divider
- Radio Options, Stereo/Cassette
- Skid Plate
- Synthetic Lubricants
- Tandem Axle Spacing Options
- Wheel Equipment:
 - Spoke or Aluminum Disc

OTHER COMPONENT OPTIONS
MAY BE AVAILABLE UPON REQUEST