



MODEL F-700T SERIES

STANDARD EQUIPMENT — Coe 4-Wheel Tractor

(Based on Model F-707T)

WHEELBASE	128" (LP 139"; CA 106")
ENGINE: (MACK)	†ET 673
Type	Turbocharged, 6 cyl.
Bore & stroke	4 $\frac{7}{8}$ " x 6"
Piston displacement, cu. in.	672
*Brake HP @ 2100 rpm	260
*Max. torque @ 1500 rpm	775 lb. ft.
Lube oil filter	Full-flow, twin spin-on disposable type
Air cleaner	Dry type
Radiator, frontal area	1,000 sq. in.
Fuel pump	Multiple plunger type
Coolant conditioner	Spin-on disposable type
Thermostat (set to open)	170°F
*Based on performance at SAE standard conditions of 500' altitude & 85°F air intake temperature.	
†Not certified for State of California.	
FUEL TANK	50 gal., right hand, steel, round
ELECTRICAL SYSTEM: Alternator	12 Volt, 85 Amp. (L/N)
Starting system	12 Volt
Batteries	4 (6) Volt
Plates per cell 23; Amp. hr. @ 20 hr. rate	165
CLUTCH:	CL 69 or CL 77
Make	Spicer Lipé
Size	14", 2-plate 14", 2-plate
Lining	Organic Organic
Area of engagement	423 sq. in. 423 sq. in.
TRANSMISSION: (MACK)	TRD 722
Type	Ten speed, direct, duplex
FRONT AXLE:	FAW 536C
Capacity	10,500 lbs.

REAR AXLE:	*RAD 529C
Capacity	23,000 lbs.
Carrier	CRD 117
Ratios	3.71, 4.00, 4.25, 4.62, 4.88, 5.43, 5.78,
*Max. GCW 75,000 lbs. 6.36, 6.80, 7.48, 7.85, 8.39, 8.83, 9.87	

SPRINGS:	Front (FAW 536C)	Rear (RAD 529C)
Ground load rating	10,500 lbs.	23,000 lbs.
Size	55" x 3 $\frac{1}{2}$ "	53 $\frac{3}{4}$ " x 3"
Leaves, no. & thickness	3 tapered @ .726"	9 @ .558"
Pack thickness @ axle spring pad	2.432"	

BRAKES: Air	MACK 12.9 CFM — M/R EL-1300 air compressor
Front (cam type)	16 $\frac{1}{2}$ " x 5" (314 sq. in.)
Rear (cam type)	16 $\frac{1}{2}$ " x 7" (440 sq. in.)
Auxiliary	Spring loaded type

AIR RESERVOIRS	ONE (Two compartment)
Location	Right frame rail
Capacity (Total)	6,234 cu. in.

WHEELS AND TIRES:	Cast spoke
Wheels	10.00-20 (12P) 7.5 rims
Tires	

STEERING GEAR: Model	SG 261
Steering wheel diameter; ratio	21"; 32.5:1

FRAME:	Material	Section	RBM in lbs.
	Heat-treated	Modulus	Per Rail
Size	110,000 PSI	16.65	1,830,000
13 $\frac{1}{8}$ " x 3 $\frac{1}{4}$ " x $\frac{1}{4}$ " (Deep Section)	Minimum Yield Strength Steel		

CAB: (MACK)	CA 47 (No rider's seat)
Type (50.5" BBC)	Cab over engine

STANDARD CHASSIS WEIGHT (EST. LBS.)
Front 7,618; Rear 3,917; Total 11,535

CHASSIS EQUIPMENT

Automatic reset circuit breakers	Horn, electric, single tone
Back-up light	I.D. & clearance lamps
Break-away safety valve	Low air pressure buzzer
Cab roof vent, two way	Rear view mirror, two,
Cab step — L. side & R. side	West Coast type
Combination heater and def., 42,000 BTU	Seat belts
Combination stop, tail & rear turn signals (2)	Shock absorbers, front (strut type)
Engine water conditioner (Cummins engine)	Side marker lights & reflectors
Engine stop control	Step (left side) battery box mounted (access to rear of cab)
	Sun visor, left side

Tachometer, single hand
Trailer conn., semi-trailer
Turn signals, front & rear (with 4-way flasher)
Undercoating
Vertical exhaust
Voltmeter
Warning light for spring loaded aux. brakes
Wheel wrench and handle
Windshield glass, Solex
Windshield washers

Windshield wipers, dual, air,
two motors
MANDATORY
OPTIONAL EQUIPMENT
FMVSS 121 Brake System
with Eaton, Anti-Wheel Lock
Brake System

MACK TRUCKS, INC.

ONE OF THE SIGNAL COMPANIES 

OPTIONAL EQUIPMENT — F-700T Series

See Power Train Combination

ENGINE	CHASSIS MODEL	BORE & STROKE	NO. OF CYL.	CU. IN. DISP.	*BHP @ RPM	*MAX. TORQUE @ RPM	RADIATOR SQ. IN.
††ETAZ 673A	F 712T	4 $\frac{7}{8}$ " x 6"	6	672	315 @ 1900	1050 @ 1450	1,000
††NTC 290	F 747T	5 $\frac{1}{2}$ " x 6"	6	855	290 @ 2100	930 @ 1300	1,110
††NTC 290	F 747T	5 $\frac{1}{2}$ " x 6"	6	855	270 @ 2100	930 @ 1300	1,110
††FORMULA 290	F 747T	5 $\frac{1}{2}$ " x 6"	6	855	290 @ 1900	930 @ 1300	1,110
††FORMULA 290	F 747T	5 $\frac{1}{2}$ " x 6"	6	855	270 @ 1900	930 @ 1300	1,110
†ENDT 675 (MAXIDYNE) ††ENDT 675C	F 785T	4 $\frac{7}{8}$ " x 6"	6	672	**237 @ 1700 (Max.) **235 @ 2100 (Gov'd)	**906 @ 1200	1,000
††ENDT 676 (MAXIDYNE)	F 786T	4 $\frac{7}{8}$ " x 6"	6	672	285 @ 1800 (Max.) 283 @ 2100 (Gov'd)	1080 @ 1200	1,000
†ENDT 865 (V-8 MAXIDYNE)	F 795T	5 $\frac{1}{4}$ " x 5"	8	866	**325 @ 2100 (Max.) **322 @ 2400 (Gov'd)	**1100 @ 1350	1,110
††ENDT 865C (V-8 MAXIDYNE)	F 795T	5 $\frac{1}{4}$ " x 5"	8	866	**325 @ 1800 (Max.) **317 @ 2100 (Gov'd)	**1211 @ 1350	1,110

*Based on performance at SAE standard conditions of 500' altitude & 85°F air intake temperature.

**Based on performance at sea level & 60°F dry air intake temperature.

†Not certified for State of California.

††Certified for State of California.

WHEELBASE 135", 143", 156"

(See chassis diagram for platform, etc.)

CLUTCH: See Power Train Combination

CL 692 Spicer, 14" 2-plate (org.)	423 sq. in.
CL 721 "Dynamax" 4-plate (org.) wet	578 sq. in.
CL 75 Spicer, 14" 2-plate (cer.)	144 sq. in.
CL 75 Spicer, 14" 2-plate (cer.)	144 sq. in.
CL(S) 751 Spicer, 14" 2-plate (cer.)	144 sq. in.
CL 772 Lipe, 14" 2-plate (cer.) (org.)	423 sq. in.
CL 78 Lipe, 14" 2-plate (cer.)	125 sq. in.
CL 781 Lipe, 14" 2-plate (cer.)	125 sq. in.
CL 79 Spicer, 15 $\frac{1}{2}$ " 2-plate (cer.)	144 sq. in.
CL(S) 791 Spicer, 15 $\frac{1}{2}$ " 2-plate (cer.)	144 sq. in.

NOTE: All clutches are pull type (except CL 721 which is a Rockford push type).

LININGS: cer. - ceramic; org. - organic

SELF-ADJUSTING FEATURE — (S)

CAB:

CAS 48 Sleeper, incl. mattress, sleeper bunk safety straps & helper seat (86.5" BBC)

WHEELS AND TIRES:

Disc (7.5 rims)	Alum., Hi-Tensile or Accu-ride
(8.0 rims)	Steel
Tires and rims	10.00-22 (12P) 7.5 rim
	11.00-20 or 11.00-22 (12P) 8.0 rim

ELECTRICAL SYSTEM:

Starting 24 Volt

ALTERNATOR: 12 Volt 90 Amp. (Delco)

BATTERIES (4) 6 Volt

Plates per cell 29

Amp. hr. @ 20 hr. rate 220

FRONT AXLES:

FAW 536C-W-D	10,500 lbs. capacity
Springs:	(STD.) (OPT.)
Ground load ratings	10,500 lbs. 9,500 lbs.
Size	55" x 3 $\frac{1}{2}$ " 55" x 3 $\frac{1}{2}$ "
Leaves, No. & thickness	3 tapered 3 tapered
	@ .726" @ .620"
Pack thickness @ axle spring pad	2.432" 2.312"
Brakes: Cam type	16 $\frac{1}{2}$ " x 5" (314 sq. in.)
Wedge type	15" x 5" (314 sq. in.)
Disc type	Single sliding caliper disc
Rotor, type & O.D.	Ventilated, 15.62"
Lining area, total	115.68 sq. in.

FAW 537C-W-D	12,000 lbs. capacity
Springs:	(STD.) (OPT.) (OPT. H.D.)
Ground load ratings	12,000 lbs. 10,500 lbs. 12,000 lbs.
Size	55" x 3 $\frac{1}{2}$ " 55" x 3 $\frac{1}{2}$ " 55" x 3 $\frac{1}{2}$ "
Leaves, No. & thickness	3 tapered 3 tapered 3 tapered
	@ .715" @ .726" @ .770"
Pack thickness @ axle spring pad	2.597" 2.432" 2.762"
Brakes: Cam type	16 $\frac{1}{2}$ " x 5" (314 sq. in.)
Wedge type	15" x 5" (314 sq. in.)
Disc type	Single sliding caliper disc
Rotor, type & O.D.	Ventilated, 15.62"
Lining area, total	115.68 sq. in.

NOTE: Front axles with disc brakes and 20" wheel equip., require tubeless tires.

POWER STEERING Integral SGP 45 (Hydraulic)

REAR AXLES: See Power Train Combinations

RAD 529C	23,000 lbs. capacity		
Carrier	CRD 117		
Ratios	3.71, 4.00, 4.25, 4.62, 4.88, 5.43, 5.78, 6.36, 6.80, 7.48	(STD.)	(OPT.) (OPT. H.D.)
Springs:	(STD.)	(OPT.)	(OPT. H.D.)
Ground load ratings	23,000 lbs.	19,000 lbs.	23,000 lbs.
Size	53 $\frac{3}{4}$ " x 3"	53 $\frac{3}{4}$ " x 3"	53 $\frac{3}{4}$ " x 3"
Leaves, no. & thickness	9 @ .558"	6 @ .558" 2 @ .499"	11 @ .558"
Brakes: Cam type	16 $\frac{1}{2}$ " x 7" (440 sq. in.)		
RAD 533C	23,000 lbs. capacity		
Carrier	CRD 119		
Ratios	4.60, 4.99, 5.52, 5.98, 6.52, 7.21, 7.81, 8.52	(STD.)	(OPT.) (OPT. H.D.)
Springs:	(STD.)	(OPT.)	(OPT. H.D.)
Ground load ratings	23,000 lbs.	19,000 lbs.	23,000 lbs.
Size	53 $\frac{3}{4}$ " x 3"	53 $\frac{3}{4}$ " x 3"	53 $\frac{3}{4}$ " x 3"
Leaves, no. & thickness	9 @ .558"	6 @ .558" 2 @ .499"	11 @ .558"
Brakes: Cam type	16 $\frac{1}{2}$ " x 7" (440 sq. in.)		
R 170C-W	23,000 lbs. capacity		
Ratios	3.70, 4.11, 4.33, 4.62, 4.87, 5.28, 6.14, 6.83, 7.40	(STD.)	(OPT.)
Springs:	(STD.)	(OPT.)	
Ground load ratings	23,000 lbs.	19,000 lbs.	
Size	53 $\frac{3}{4}$ " x 3"	53 $\frac{3}{4}$ " x 3"	
Leaves, no. & thickness	9 @ .558"	6 @ .558" 2 @ .499"	
Brakes: Cam type	16 $\frac{1}{2}$ " x 7" (440 sq. in.)		
Wedge type	15" x 7" (440 sq. in.)		

RAD 529C maximum GCW 75,000 lbs.

TRANSMISSIONS: See Power Train Combination

Transmission	Transmission Description
TRD 7220	9 spd., overgear, duplex
TRQ 7220	18 spd., overgear, quadruplex
TRL 1076	5 spd., direct, maxitorque
TRL 1078	5 spd., direct, maxitorque
TRDL 107	10 spd., direct
TRTXL 107	12 spd., direct
RT 910	10 spd., roadranger
RTO 910	10 spd., overgear, roadranger
RT 9513	13 spd., direct, roadranger
RTO 9513	13 spd., overgear, roadranger
RT 915	15 spd., roadranger
RTO 915	15 spd., overgear, roadranger

HELPER SPRINGS, REAR:

Size 36" x 3"
Leaves, No. & thickness 8 @ .291"

AIR CLEANERS: See Data Book Engine Section

FUEL TANKS:

Type Round, 26" dia.
Material Steel or Aluminum

Location & Minimum Wheelbase:

Size	L.H.	R.H.
40 gal.	128"	128"
50 gal.	128"	128"
60 gal.	128"	128"
70 gal.	135"	128"
80 gal.	135"	128"
90 gal.	143"	128"
100 gal.	143"	128"
110 gal.	156"	128"
120 gal.	156"	135"

NOTE: When both L.H. and R.H. fuel tanks are specified, longest charted minimum wheelbase applies.

LIGHTWEIGHT ITEMS:

Aluminum Brackets Engine front support crossmember, engine rear support and transmission support frame brackets.
Aluminum Cab CAL 47, CASL 48, cab doors, cab roof, door skirt and headlight panel.
Aluminum Carrier Housing R 170C-W only
Aluminum Bumper

	Transmission Description
T 955GL	6 spd., direct
RT 9509A	9 spd., direct, roadranger
RT 1110	10 spd., direct, roadranger
RT 1110	10 spd., overgear, roadranger
RT 12510	10 spd., direct, roadranger
RTO 12510	10 spd., overgear, roadranger
RT 12513	13 spd., direct, roadranger
RTO 12513	13 spd., overgear, roadranger
HT 740 D (Allison)	4 spd., automatic
HT 750 CRD (Allison)	5 spd., automatic
HT 750 DRD (Allison)	5 spd., automatic

OPTIONAL CHASSIS EQUIPMENT

Air intake system
outside — under cab
Air starting
Air suspended cab mounting
Alcohol evaporator
Automatic drain valve
Cab air conditioning
Chrome plated grill
Chrome plated turn signals (front)
Chrome plated W.C. type rear view mirrors
Deluxe cab interior (CAD(L)47 - CASD(L)48)
Deluxe interior sleeper bunk trim
Differential, Mack power divider
(for dual reduction rear axle)
Driver's seat — Bostrom; Viking T-Bar,
West Coaster or Levelair; American
Metal, unison action, Mack suspension;
National Cush-N-Aire

Electric window lift — R.H. side
Engine brake
Engine lube oil filter:
By-pass type in addition to std. full-flow
Cummins only — required w/NTC 290)
Engine puff limiter
(Required w/ETAZ 673, ENDT 675,
ENDT 676, ETAZ 673A & ENDT 865)
Ether applicator
Exhaust pyrometer
(Required w/ETAZ 673A & ENDT 676)
Hand control valve
Helper seat
Horn, air, twin or single
Horn, electric, dual tone
Hubodometer
Hydraulic jack, 8 or 12 ton
Mack Bulldog mirrors

Maxi-Miser fuel conserver
(w/ENDT 675 or ENDT 676 only)
Oil level indicator, remote (Mack engines)
Radiator shutters, automatic
Rider seat
Rider's seat arm rest
Seat belt retractors
Sun visor, right side
Tachograph (RPM and/or MPH)
Tow shackle, bumper mounted (Removable)
Trailer conn., full trailer (No hose)
Underframe exhaust
Wig-wag low air pressure indicator

F-700T SERIES RECOMMENDED POWER TRAIN COMBINATIONS

ENGINE†	CLUTCH	TRANSMISSION	*DRIVE-SHAFT SERIES	REAR AXLE
ET 673 (MACK 12.9 CFM)	CL 69 CL 75 CL 77 CL 78 CL 79	TRD 722	1710	RAD 529C RAD 533C R 170C-W
		TRD 7220	1710	
		TRQ 7220	1710 H.D.	
		RT 910	1710	
RT 910	1710			
RT 9513	1710 H.D.			
RT 915	1710			
RT 915	1710			
HT 740 D	1710			
HT 750 CRD	1710			
HT 750 DRD	1810			
ETAZ 673A (MACK 12.9 CFM)	CL 75 CL(S) 751 CL 78 CL 781 CL 79 CL(S) 791	TRDL 107	1810	
		TRTXL 107	1880	
		RT 1110	1710 H.D.	
		RT 1110	1710	
RT 12510	1710 H.D.			
RT 12510	1710			
RT 12513	1810 H.D.			
RT 12513	1810 H.D.			
HT 740 D				
HT 750 CRD				
HT 750 DRD				
NTC 290 (Cummins 13.2 CFM)	CL 692 CL(S) 751 CL 772 CL 781 CL(S) 791	T 955 GL	1880	
		RT 9509 A	1710 H.D.	
		RT 1110	1710	
		TRDL 107	1880	
HT 740 D				
HT 750 CRD				
HT 750 DRD				
FORMULA 290 (Cummins 13.2 CFM)	CL 692 CL(S) 751 CL 772 CL 781 CL(S) 791	RT 9509 A	1710 H.D.	
		RT 1110	1710	
		TRDL 107	1880	
		HT 740 D		
HT 750 CRD				
HT 750 DRD				

ENGINE†	CLUTCH	TRANSMISSION	*DRIVE-SHAFT SERIES	REAR AXLE
ENDT 675 (MACK 12.5 CFM) (Maxidyne) ENDT 675C (MACK 12.9 CFM)	CL 69 CL 75 CL 77 CL 78 CL 79 CL 721	TRL 1076	1710	RAD 529C RAD 533C R 170C-W
		TRL 1078	1710	
HT 740 D	1710			
HT 750 DRD	1810 H.D.			
ENDT 676 (MACK 12.5 CFM) (Maxidyne) (MACK 12.9 CFM)	CL 75 CL 78 CL 79 CL 721	TRL 1076	1810	
		TRL 1078	1810	
HT 740 D	1810			
HT 750 DRD	1880			
ENDT 865 (Maxidyne) ENDT 865C (MACK 12.5 CFM)	CL 78 CL 79 CL 721 CL 75	TRL 1076	1810	
		TRL 1078	1810	
HT 740 D	1810			
HT 750 DRD	1880			

*DRIVESHAFT SERIES REPRESENTS SIZE, NOT MANUFACTURER.

†STANDARD AIR COMPRESSOR SHOWN.

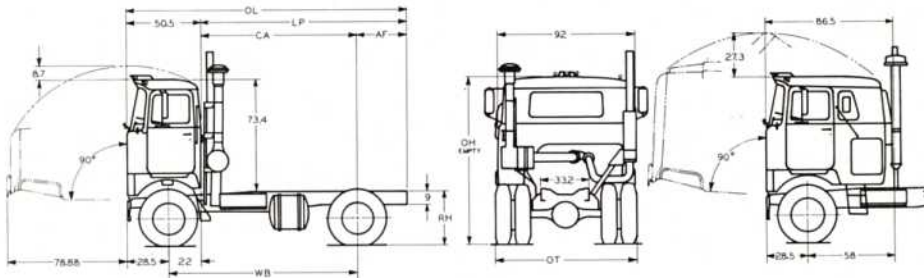

WB	Standard Cab CA 47		Sleeper Cab CAS 48		AF	OL	Turning Circle Dia. (Outer edge of tire) Est.	
	LP	CA	LP	CA			Right	Left
128	139	106	103	70	33	189.5	49 ft.	49 ft.
135	146	113	110	77	33	196.5	51 ft.	51 ft.
143	154	121	118	85	33	204.5	53 ft.	53 ft.
156	167	134	131	98	33	217.5	57 ft.	57 ft.

Chassis dimensions are in inches and are for standard chassis unless otherwise denoted.

TIRE SIZE	OH Approx.	RH		OT
		Empty	Loaded	
10.00-20	114.6	41.2	37.5	95.3
10.00-22	115.6	42.2	38.5	95.3
11.00-20	115.2	41.8	38.1	96.0
11.00-22	116.2	42.8	39.1	96.0

Frame heights are subject to variations: 1" empty, 1/2" loaded.